

# Skate Deterrents Button Series



Tactile Systems Australia's Skate Deterrents are the ideal way to protect property from the damage caused by skaters and skateboarders.

Our Button Series deterrents are manufactured from marine grade stainless steel or high grade brass, allowing protection to your property, without adversely affecting the appearance of the protected area.

They are suitable for use on a wide range of surfaces, such as planters, retaining walls, handrails, benches etc.

They feature concealed fixings for secure installation.

30mm diameter head, bevelled edges, 20mm stem and 20mm button height.

Tactile Systems skate deterrents have been used in hundreds of applications all over Australia, as well being exported to the USA, New Zealand and PNG.

Install with TSA 2 part epoxy adhesive for secure and long lasting service - TSA-PE-500SD

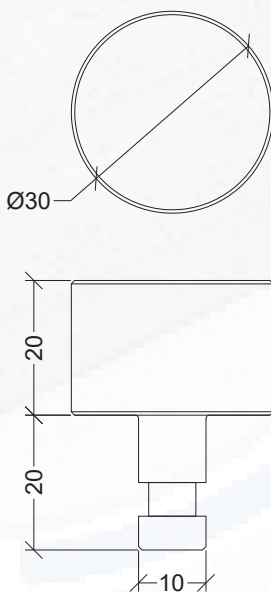

### SPECIFICATIONS

Type	Code
Stainless Steel	SDB-30-SS
Brass	SDB-30-BR

### SUITABLE SUBSTRATES

Tiles	Concrete	Bitumen
Timber	Rubber	Exp Aggregate
Vinyl	Pavers	



2 YEAR PRODUCT WARRANTY



INSTALLATION SERVICE AVAILABLE